

Notes
 © Arcus Consulting
 THIS DRAWING IS THE SUBJECT OF COPYRIGHT WHICH VESTS IN ARCUS CONSULTING. IT IS AN INFRINGEMENT OF COPYRIGHT TO REPRODUCE THIS DRAWING BY WHATEVER MEANS, INCLUDING ELECTRONIC, WITHOUT THE EXPRESS WRITTEN CONSENT OF ARCUS CONSULTING WHICH RESERVES ALL ITS RIGHTS.
 ARCUS CONSULTING ASSERTS ITS RIGHTS TO BE IDENTIFIED AS THE AUTHOR OF THIS DESIGN. ALL DRAWINGS, IMAGES AND MODELS ARE SUBJECT TO THE COPYRIGHT, DESIGNS & PATENTS ACT 1988.
 DRAWING NOT TO BE SCALED.
 REPORT ERRORS & OMISSIONS TO ARCHITECT.
 CHECK ALL DIMENSIONS ON SITE.
 DRAWING TO BE READ IN CONJUNCTION WITH HEALTH AND SAFETY PLAN AND ALL RELEVANT RISK ASSESSMENTS.
 Safety Health and Environmental Information Box
 In addition to the hazards/risks normally associated with the types of work detailed on this drawing take note of below. It is assumed that all works on this drawing will be carried out by a competent contractor working, where appropriate, to an appropriate method statement.
 Residual

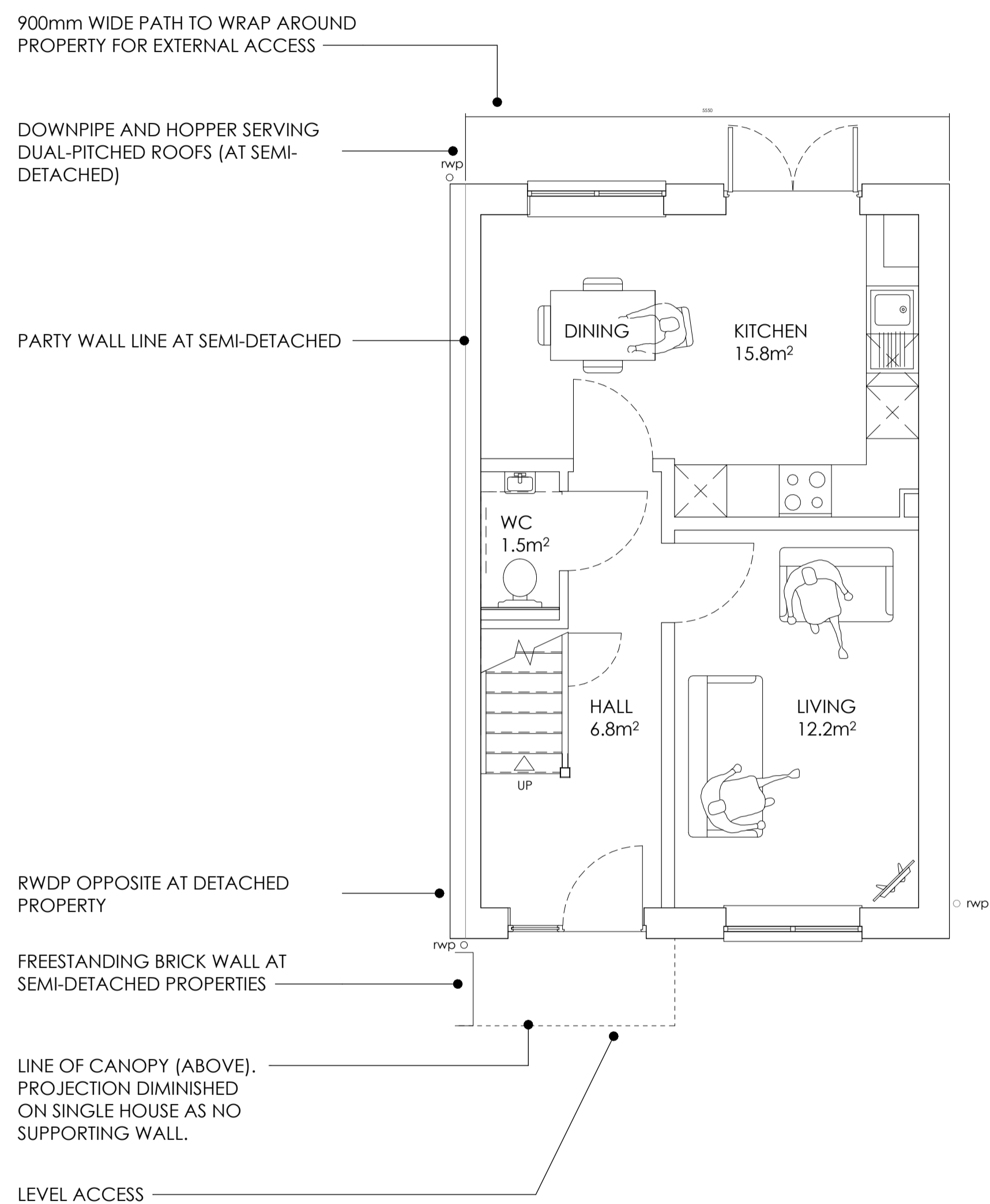

LEVEL 00

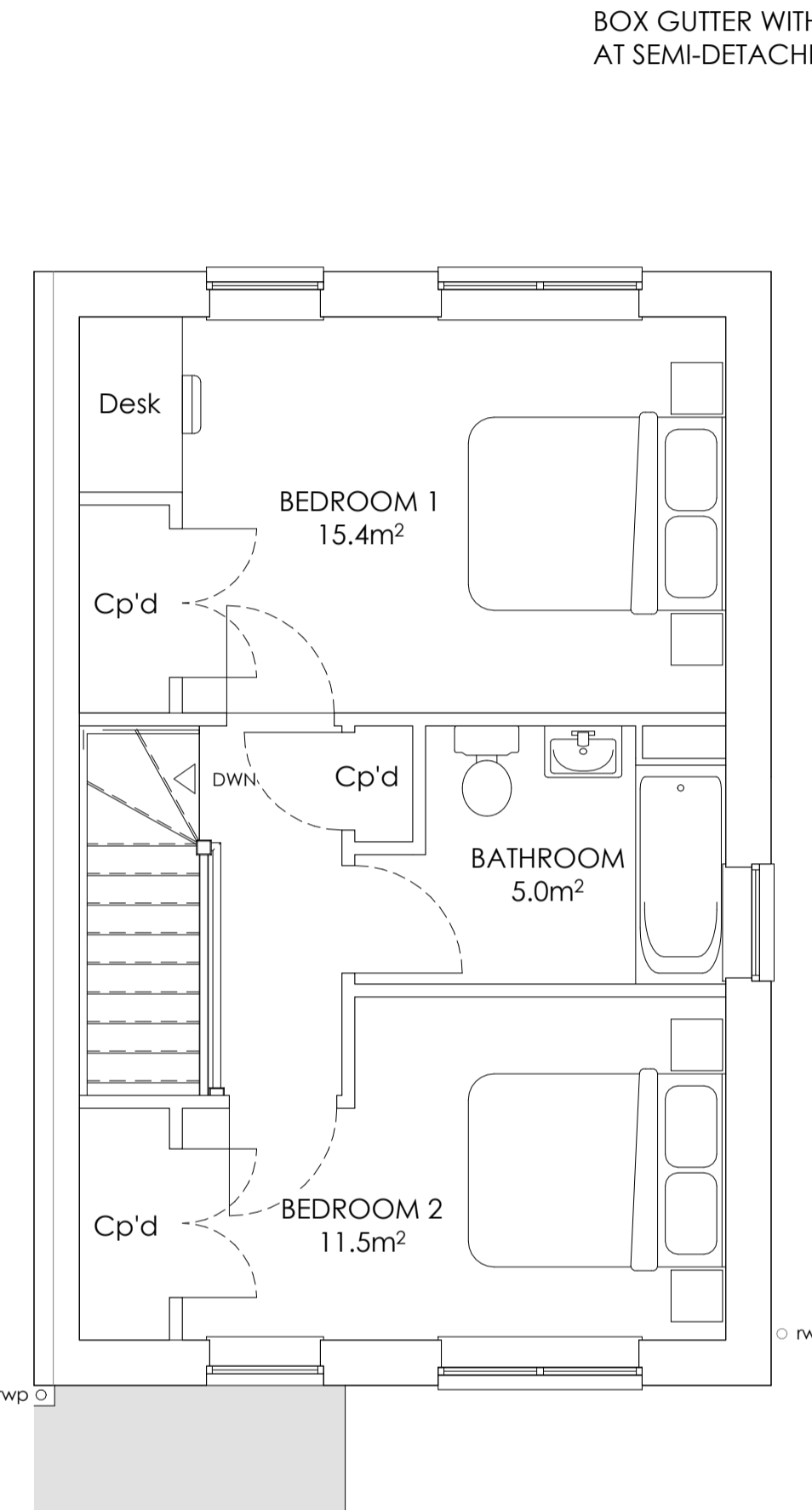

LEVEL 01

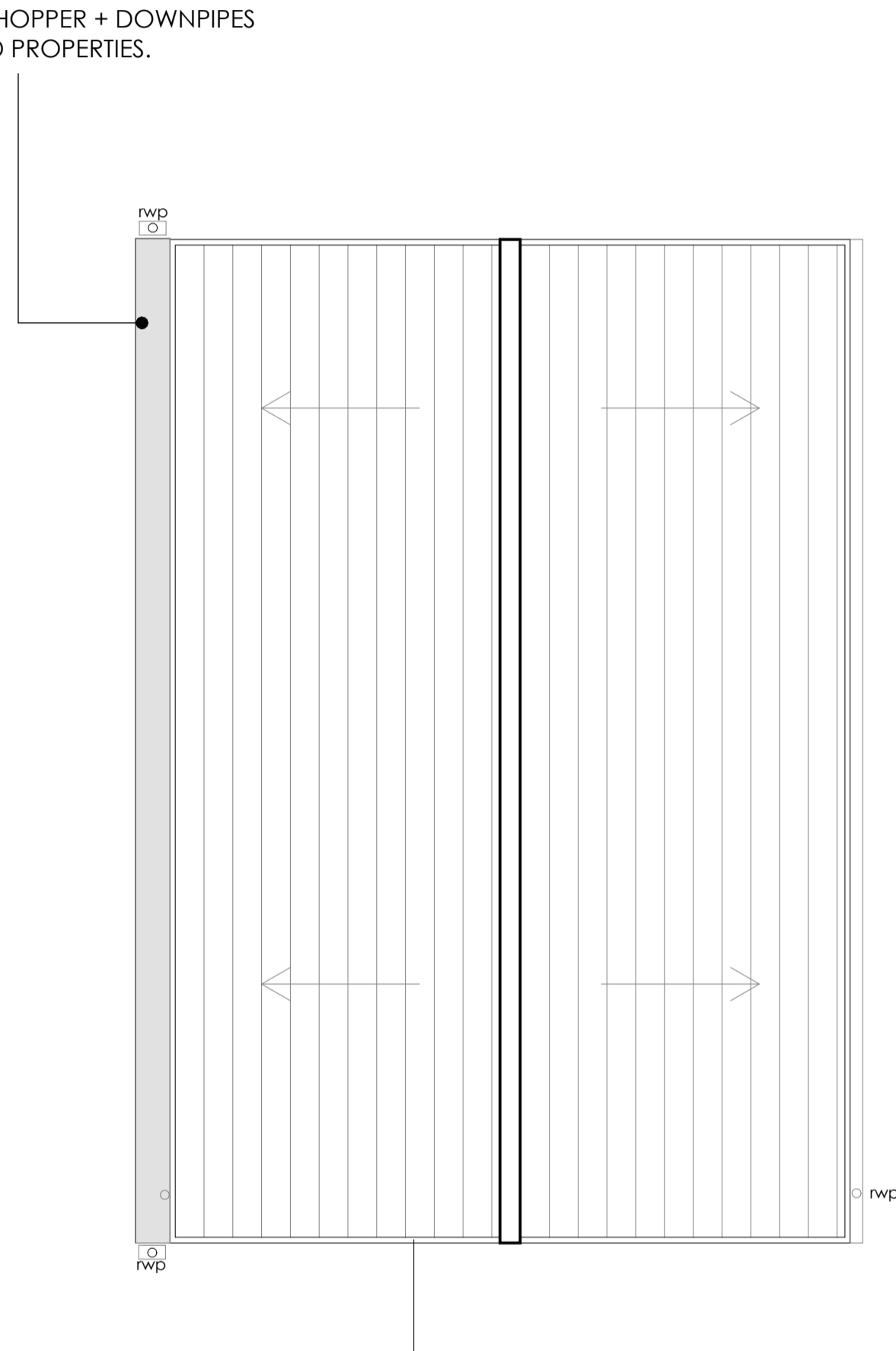

ROOF

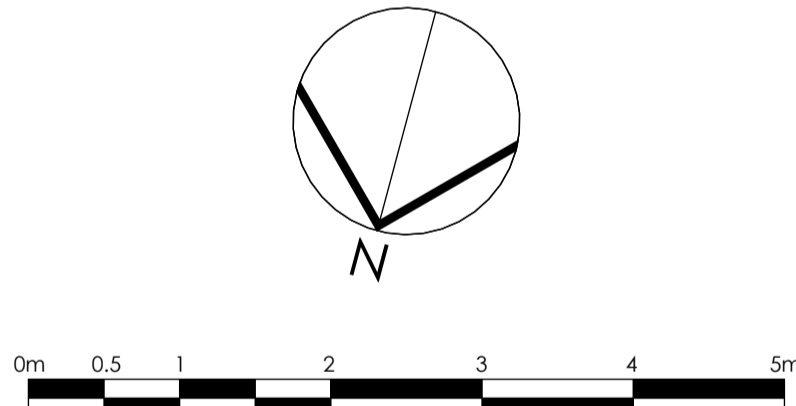

Rev	Revision Notes	Date
P1	CLIENT ISSUE	16/05/24
P2	Changes to furniture layout	17/07/24
P3	PLANNING ISSUE	09/08/24
P4	AMENDED TO PLANNING OFFICER COMMENTS	27/08/24

Drawing Status:	PLANNING	Suitability:	S3
Job Title:	CLIFFORD ROAD	Job No:	7504
Drawing Title:	PROPOSED HOUSE TYPE PLANS		
Date:	Scale @A1:	Drawn By:	Checked By:
27/08/24	1 : 50	AH	PG
Drawing No:	7504-ARC-00-XX-DR-A-010001		Rev:
			P4